



I-10/TIPPECANOE INTERCHANGE IMPROVEMENT PROJECT: PHASE II

UPCOMING CLOSURES MAY 31 - JUNE 5, 2015

1	Interstate 10 (I-10) Westbound <i>off-ramp at Tippecanoe Ave</i> <i>Full Ramp Closure</i>	Sunday, May 31, 2015 through Friday, June 5, 2015 from 10:00 p.m. to 5:00 a.m. <i>Installation of storm drain</i>
2	Interstate 10 (I-10) Eastbound <i>off-ramp at Tippecanoe Ave / Anderson St</i> <i>Left Turn Lane Closed</i>	Sunday, May 31, 2015 through Friday, June 5, 2015 from 10:00 p.m. to 5:00 a.m. <i>Installation of storm drain</i>
3	Northbound Anderson St / Tippecanoe Ave from the eastbound on-ramp to Lee Street <i>Reduced to One Lane</i>	Sunday, May 31, 2015 through Friday, June 5, 2015 from 10:00 p.m. to 6:00 a.m. <i>Installation of storm drain</i>

Due to unforeseen issues or inclement weather, these dates and times are subject to change. Motorists and pedestrians should use caution while traveling through work zones near barricades and equipment.

Thank you for your patience and support during this improvement project. Please adhere to all posted signage in the construction zone and always remember to... **SLOW FOR THE CONE ZONE.**

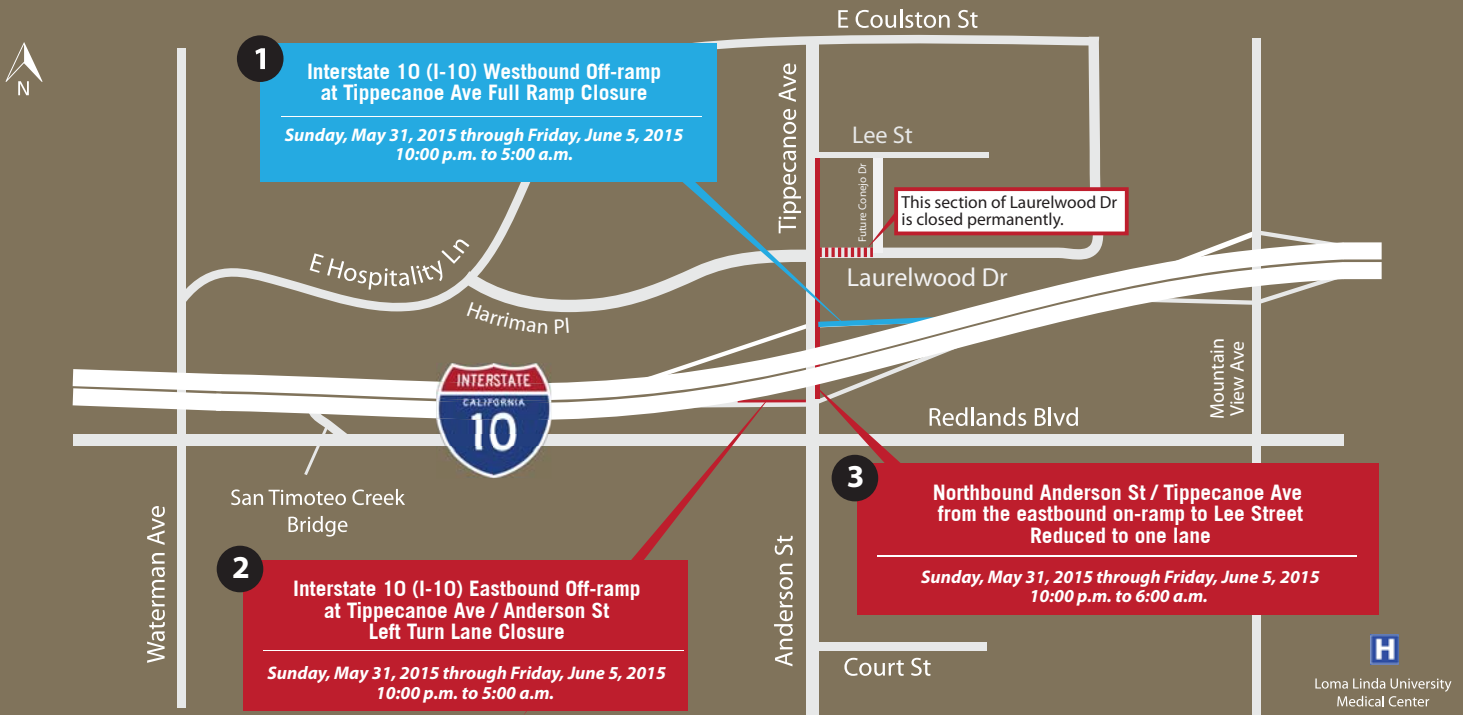

For more information, please contact:
Project Help Line: (800) 875-4990
Tim Watkins, Legislative and Public Affairs, SANBAG
Email: twatkins@sanbag.ca.gov

Follow Our Project:
www.sanbag.ca.gov/projects

